

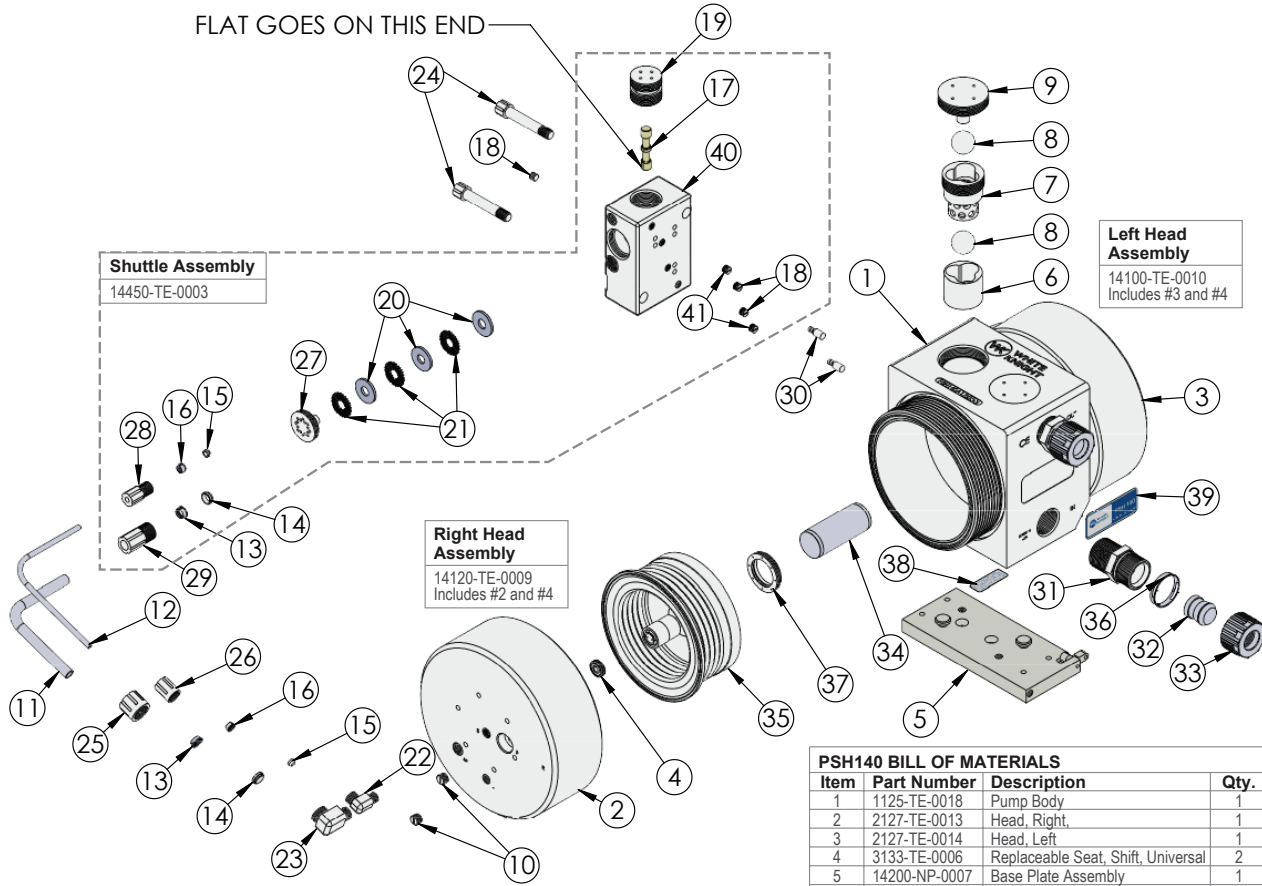

## PSH140 Exploded View



Leak Detect		
Part		Description
14600-XX-0009	LF0	15 ft fiber optic cable with no amplifier
14600-XX-0010	LF1	15 ft fiber optic cable with D10 amplifier
14600-XX-0011	LF2	25 ft fiber optic cable with no amplifier
14600-XX-0012	LF3	25 ft fiber optic cable with D10 amplifier
14600-XX-0031	LC0	15 ft conductivity cable
14600-XX-0040	LC1	25 ft conductivity cable

Stroke Detect with Fiber Optics		
Part		Description
14700-XX-0013	SF0	15 ft fiber optic cable with no amplifier
14700-XX-0014	SF1	15 ft fiber optic cable with D10 amplifier
14700-XX-0015	SF2	25 ft fiber optic cable with no amplifier
14700-XX-0016	SF3	25 ft fiber optic cable with D10 amplifier

Stroke Detect with Pressure Switch		
Part		Description
14900-NP-0004	SP1	Single NPN Switch
14900-NP-0003	SP2	Dual NPN Switches
14900-NP-0001	SP4	Single PNP Switch
14900-NP-0002	SP5	Dual PNP Switches

Fittings (Type, Size, Option)		Assemblies		Body Inlet Only (Nut not included)
Flaretek Compatible	1/2 in. F08	14510-PF-0011	7200-PF-0015	
	3/4 in. F12	14510-PF-0008	7200-PF-0009	
	1 in. F16	14510-PF-0009	7200-PF-0010	
Tube Out	1-1/4 in. F20	14510-PF-0010	7200-PF-0011	
	3/4 in. T12		7120-PF-0007	
	1 in. T16		7120-PF-0008	
Weldable	1-1/4 in. T20		7120-PF-0009	
	1-1/2 in. T24		7120-PF-0010	
	3/4 in. W12		7300-PF-0005	
Pillar S-300	1 in. W16		7300-PF-0006	
	1/2 in. P08	14530-PF-0011	7400-TE-0019	
	3/4 in. P12	14530-PF-0006	7400-TE-0006	
FNPT	1 in. P16	14530-PF-0007	7400-TE-0007	
	1-1/4 in. P20	14530-PF-0008	7400-TE-0008	
	1-1/2 in. P24	14530-PF-0026	7400-TE-0035	
Synchro-Flare	1-1/2 in. N12		7100-TE-0009	
	1 in. N16		7100-TE-0005	
	1-1/4 in. N20		7100-TE-0010	
PrimeLock	3/4 in. S08	TBD	7010-TE-0008	
	3/4 in. S12	14520-TE-0008	7010-TE-0007	
	1 in. S16	14520-TE-0007	7010-TE-0009	
Plugged	3/4 in. L12	14570-PF-0006	7800-TE-0006	
	1 in. L16	14570-PF-0007	7800-TE-0007	
	1-1/4 in. L20	7800-PF-0008	7800-TE-0008	
	B00		7130-TE-0005	

PSH140 BILL OF MATERIALS			
Item	Part Number	Description	Qty.
1	1125-TE-0018	Pump Body	1
2	2127-TE-0013	Head, Right,	1
3	2127-TE-0014	Head, Left	1
4	3133-TE-0006	Replaceable Seat, Shift, Universal	2
5	14200-NP-0007	Base Plate Assembly	1
6	4135-MP-0004	Bottom Check Seat, High Flow	2
7	4142-MP-0003	Top Check Seat, High Flow	2
8	4100-MP-0003	1-1/8" Check Ball	4
9	4140-TE-0004	Top Check Plug	2
10	10040-TE-0003	1/4" NPT Plug	4
11	10070-PF-0004	1/2" PFA Tube	2 FT
12	10070-PF-0001	1/4" Thick Wall PFA Tubing	2 FT
13	6080-KF-0003	1/2" Gripper	4
14	6080-TE-0003	1/2" Ferrule	4
15	6080-TE-0001	1/4" Ferrule	4
16	6080-KF-0001	1/4" Gripper	4
17	6560-CE-0003	Spool	1
18	10040-TE-0002	1/8" NPT Plug	3
19	6530-TE-0003	30 gpm Shuttle End Cap	2
20	6140-FP-0004	Baffle Porous Poly	6
21	6140-PP-0002	Shuttle Mesh	6
22	6030-TE-0004	1/4" NPT X 1/4" Grp Elbow	2
23	6020-TE-0005	3/8" NPT X 1/2" Gripper Elbow	2
24	10010-TE-0016	Set Screw	2
25	6070-TE-0003	1/2" Female Gripper Nut	2
26	6070-TE-0001	1/4" Gripper Air Nut	2
27	6150-TE-0017	Muffler Cap	2
28	6070-TE-0004	1/4" Male Gripper Nut	2
29	6070-TE-0006	1/2" Male Gripper Nut	2
30	10020-TE-0004	Shuttle Pin, Spacer Alignment	2
31	7400-TE-0007	1" Pillar	2
32	7400-PF-0003	1" Super Pillar 300 Insert	2
33	7400-PF-0007	1" Super Pillar 300 Nut	2
34	5144-PF-0022	PFA Solid Shaft	1
35	14300-MP-0028	Shift Bellows Assembly	2
36	7400-PF-0019	1" Pillar Super 300 Gage Ring	2
37	5143-MP-0011	Shaft Seal	2
38	19100-PP-0005	Patent Sticker	1
39	19100-PP-0022	Product Label	1
40	14400-TE-0011	Shuttle Body & Sleeve Assembly	1
41	10040-TE-0016	1/8" NPT Plug (.053 Orifice)	2

<https://wkfluidhandling.com/psH-series/>

